



Rovatti FL3-101GA Series Flange Pump

SAE 3

01/2002

Itemized Part Listing

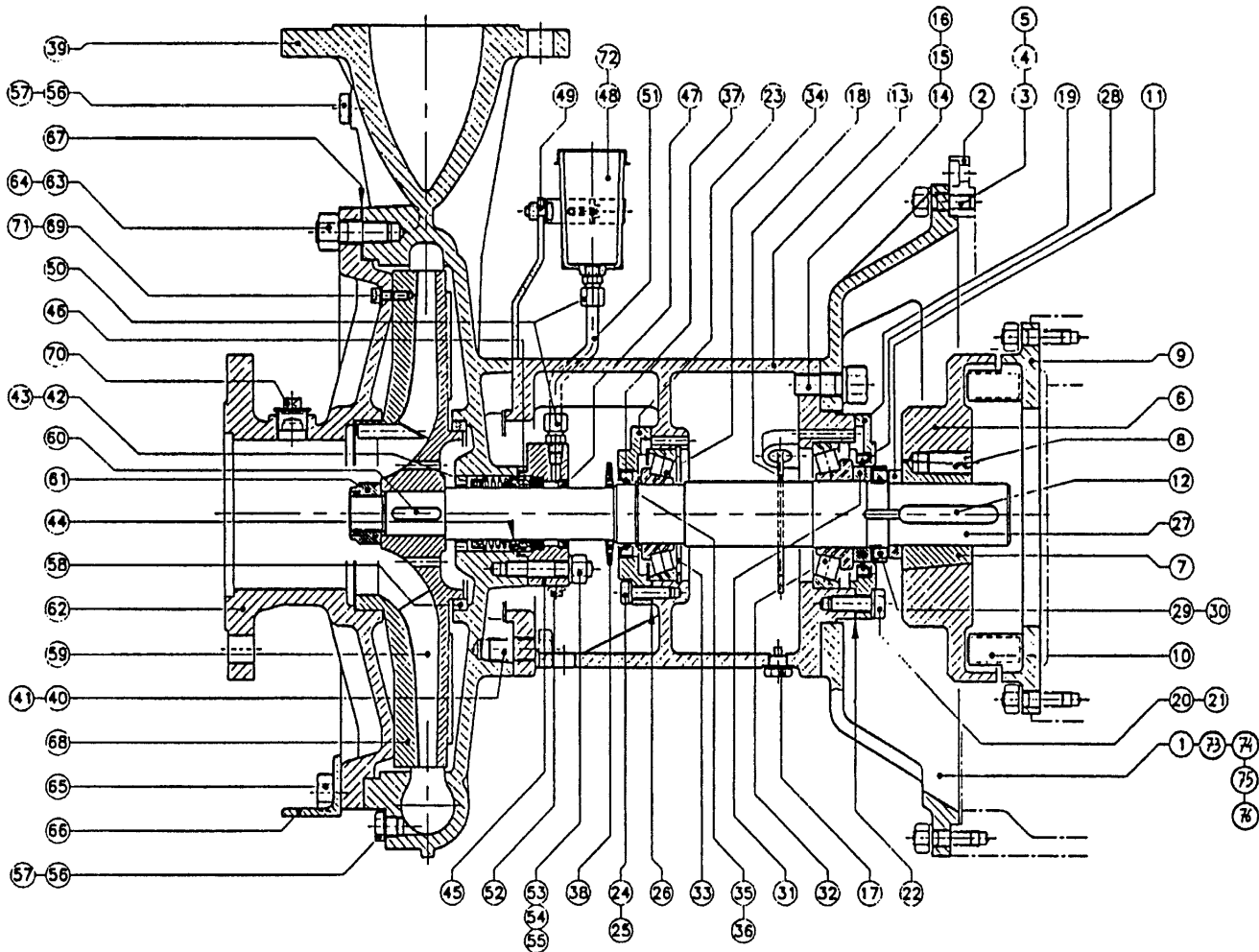

NOTE: See serial plate located on pump for ratio to indicate parts needed for POS 6, 11 and 44.

Place "RI" prefix before all part numbers before placing orders

POS	Item Description	FL3-101GA		FL3-101GA	
		Part #	Q	Part #	Q
		Mechanical Seal		Packing Rings	
1	Flange	8211	1	8211	1
2	Ring	****	**	****	**
3	Bolt / Stud	****	**	****	**
4	Nut	****	**	****	**
5	Washer	****	**	****	**
6	Coupling / 8"	8334	1	8334	1
6	Coupling / 10"	8334	1	8334	1
6	Coupling / 11-1/2"	8335	1	8335	1
7	Bushing / Taper	8337	1	8337	1
8	Bolt	VCE16	2	VCE16	2
9	Flywheel / 8"	8329	1	8329	1
9	Flywheel / 10"	8330	1	8330	1
9	Flywheel / 11-1/2"	8331	1	8331	1
10	Pad / Rubber *	8310	9	8310	9
11	Ring / Coupling Spacing / 8"	8339	1	8339	1
11	Ring / Coupling Spacing / 10"	****	**	****	**
11	Ring / Coupling Spacing / 11-1/2"	****	**	****	**
12	Key	LI39	1	LI39	1
13	Support / Bearing	12197	1	12197	1
14	Bolt / Stud	VP21	4	VP21	4
15	Nut	DEA14	4	DEA14	4

Place "RI" prefix before all part numbers before placing orders

POS	Item Description	FL3-101GA		FL3-101GA	
		Part #	Q	Part #	Q
		Mechanical Seal		Packing Rings	
16	Washer	RE14	4	RE14	4
17	Plug / Magnetic	4470	1	4470	1
18	Plug / Breather (w/ Dipstick)	7216	1	7216	1
19	Cover	12200	1	12200	1
20	Bolt	VTE4	4	VTE4	4
21	Washer	RE10	4	RE10	4
22	Gasket *	4008	1	4008	1
23	Cover	12201	1	12201	1
24	Bolt	VTE8	4	VTE8	4
25	Washer	RE8	4	RE8	4
26	Gasket *	7092	1	7092	1
27	Shaft	12198	1	12198	1
28	Seal / Oil *	AT22	1	AT22	1
29	Nut / Self Locking Ring	NO178	1	NO178	1
30	Rosette	NO179	1	NO179	1
31	Ring	12202	1	12202	1
32	Bearing *	CU96	1	CU96	1
33	Circlip / Internal	AFI9	1	AFI9	1
34	Bearing *	CU100	1	CU100	1
35	Washer	RR18	1	RR18	1
36	Circlip / External	AFE7	1	AFE7	1
37	Seal / Oil *	AT8a	1	AT8a	1
38	Ring / Water Sealing	AP4	1	AP4	1
39	Body / Pump	9612	1	13012	1
40	Bolt	VTE41	4		
41	Washer	RE14	4		
42	Ring	8700	1	7223	1
43	Rollpin	VCE18	1	****	**
44	Seal / Mechanical *	TM35V	1	****	**
44	Ring / Packing *	****	**	6420	4
45	Cover	8699	1	1034	1
46	O-Ring *	OR41	1	****	**
47	Seal / Oil *	AT18	1	****	**
48	Oiler	12550	1	13018	1
49	Guard / Oiler	****	**	****	**
50	Fitting	****	**	****	**
51	Tube / Oiler	****	**	****	**
52	Plug	NO140	1	****	**
53	Bolt / Stud	VP7	2	VP5T	2
54	Nut	DEA10	2	DEA10T	2
55	Washer	RE10	2	****	**
56	Plug	NO19	2	NO19	2
57	Washer	RA4	2	RA4	2
58	Ring / Wear *	3686	1	3686	1
59	Impeller	9944	1	9944	1
60	Key	LI12	1	LI12	1
61	Nut / Impeller	DA24b	1	DA24b	1
62	Cover / Suction	12270	1	12270	1
63	Bolt / Stud	VP21	10	VP21	10
64	Nut	DEA14	8	DEA14	8
65	Nut	DEM14	2	DEM14	2
66	Foot / Support	3762	1	3762	1
67	Gasket *	9616	3	9616	3
68	Plate / Wear *	12286	1	12286	1
69	Bolt	VTCEI44	4	VTCEI44	4
70	Plug	NO14	1	NO14	1
71	Washer	NO188	4	NO188	4
72	Plug / Oiler	****	**	****	**
73	Guard / Protection	12446	1	12446	1
74	Bolt	VTE1c	3	VTE1c	3
75	Washer	RP1	3	RP1	3
76	Nut	DEA6	3	DEA6	3
77	O-Ring *	OR57	1	OR57	1

It is useful to keep a stock of fast wearing parts on hand for quick repairs. Most recommended spare parts are marked by an asterisk (*) following part description.

1-800-Team ABI



Email abigausa@att.net
www.abi-irrigation.com



fl3-101ga.doc ABI 2003

AgriBusiness International, Inc
 P.O. Box 909
 Villa Rica, Georgia 30180 USA
 Ph. 770-459-4401 Fx. 770-459-6877