

# Rovatti MB Series Pump

Itemized Part Listing

11/2002

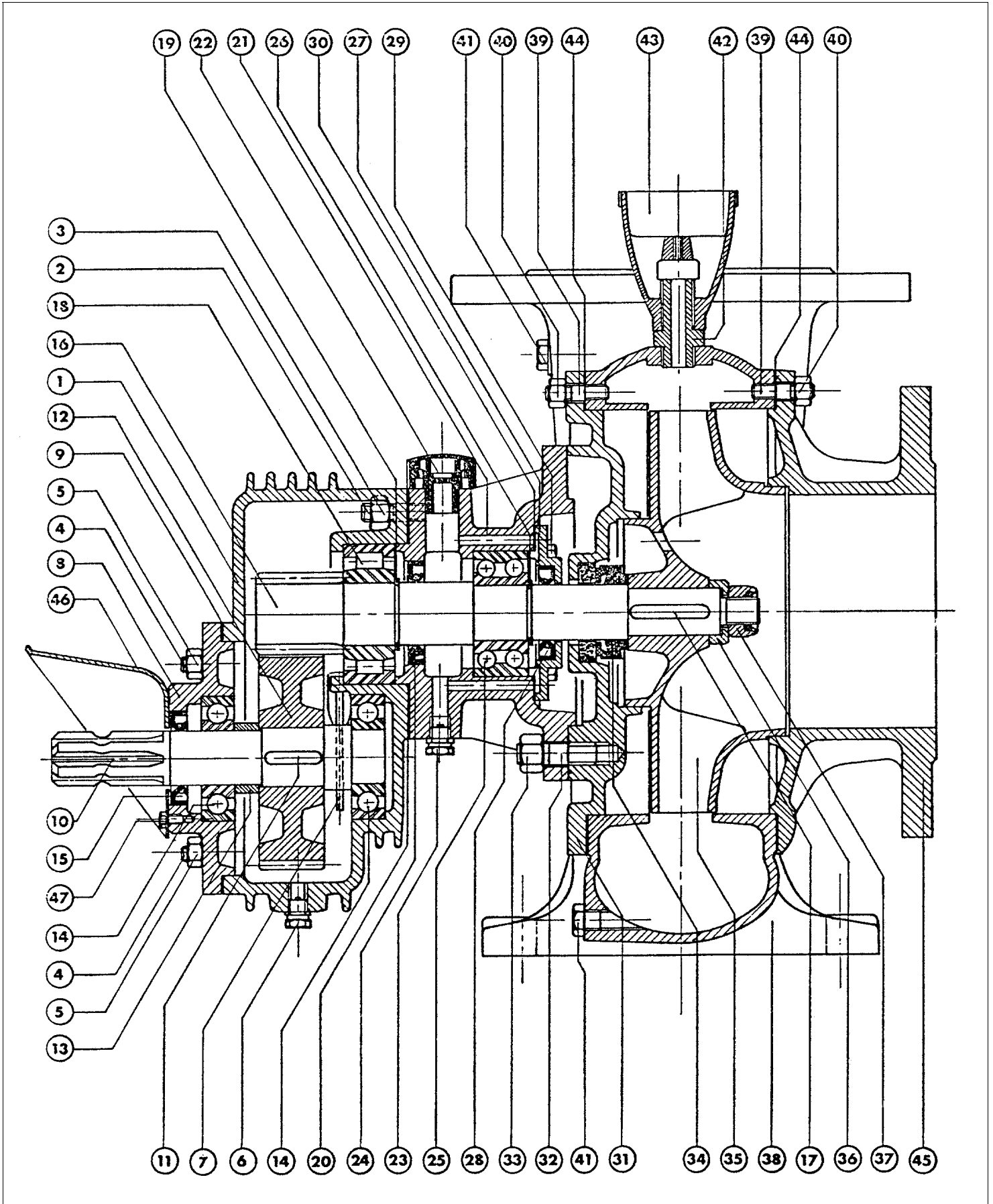

**Place "RI" prefix before all part numbers before placing orders.**

POS	Item Description	MB 20		MB 25	
		Part #	Q	Part #	Q
1	Gearbox	4926	1		
2	Bolt / Stud	VP16	4		
3	Nut / Hex	DEA12	4		
4	Bolt / Stud	VP3	4		
5	Nut / Hex	DEA10	4		
6	Plug / Magnetic	4470	1		
7	Dipstick / Oil Level	3405	1		
8	Cover	4826	1		
9	Gasket *	4830	1		
10	Shaft / PTO	3899	1		
11	Key	LI12	1		
12	Transmission Gear Z43-R.2, 87	4943	1		
12	Transmission Gear Z44-R. ,14	4940	1		
13	Spacer	3403	1		
14	Bearing *	CU9	2		
15	Seal /Oil *	AT7	1		
16	Shaft / Pinion Z15 – R, .2,87	4944	1		
16	Shaft / Pinion Z14 – R, .3,14	4942	1		
17	Key	LI13	1		
18	Bearing *	CU42	1		
19	Washer / Outer Spring	AFE7	1		
20	Gasket *	4829	1		
21	Support / Over-Gear	4924	1		
22	Plug / Breather	3370	1		
23	Plug / Magnetic	4470	1		
24	Seal / Oil *	AT15	1		
25	Bearing *	CU21	1		
26	Washer / Outer Spring	AFE5	1		
27	Cover	3903	1		
28	Seal / Oil *	AT7	1		
29	Bolt / Hex	VTE2	4		
30	Gasket *	3355	1		
31	Support / Pump	4929	1		
32	Bolt / Stud	VP21	4		
33	Nut / Hex	DEA14	4		
34	Seal / Mechanical *	TM35	1		
35	Impeller *	4947	1		
36	Washer	****			
37	Nut / Self Locking	DA24B	1		
38	Body / Pump	2528	1		
39	Bolt / Stud	VP4	16		
40	Nut / Hex	DEA10	16		
41	Plug	NO19	2		
42	Plug	NO14	1		
44	Gasket *	2536	2		
45	Cover / Suction	5574	1		
46	Cover / PTO	4477	1		
47	Bolt / Hex	VTE56	3		

NOTE: See serial plate located on pump for ratio to indicate parts needed for POS 12 and 16.

It is useful to keep a stock of fast wearing parts on hand for quick repairs. Most recommended spare parts are marked by an asterisk (\*) following part description.

**1-800-Team ABI**

Email [abigausa@att.net](mailto:abigausa@att.net)  
[www.abi-irrigation.com](http://www.abi-irrigation.com)

mb.pdf ABI 2002



**AgriBusiness International, Inc**  
P.O. Box 909  
Villa Rica, Georgia 30180 USA  
Ph. 770-459-4401 Fx. 770-459-6877