

Rovatti MB Series Pump

Itemized Part Listing

11/2002

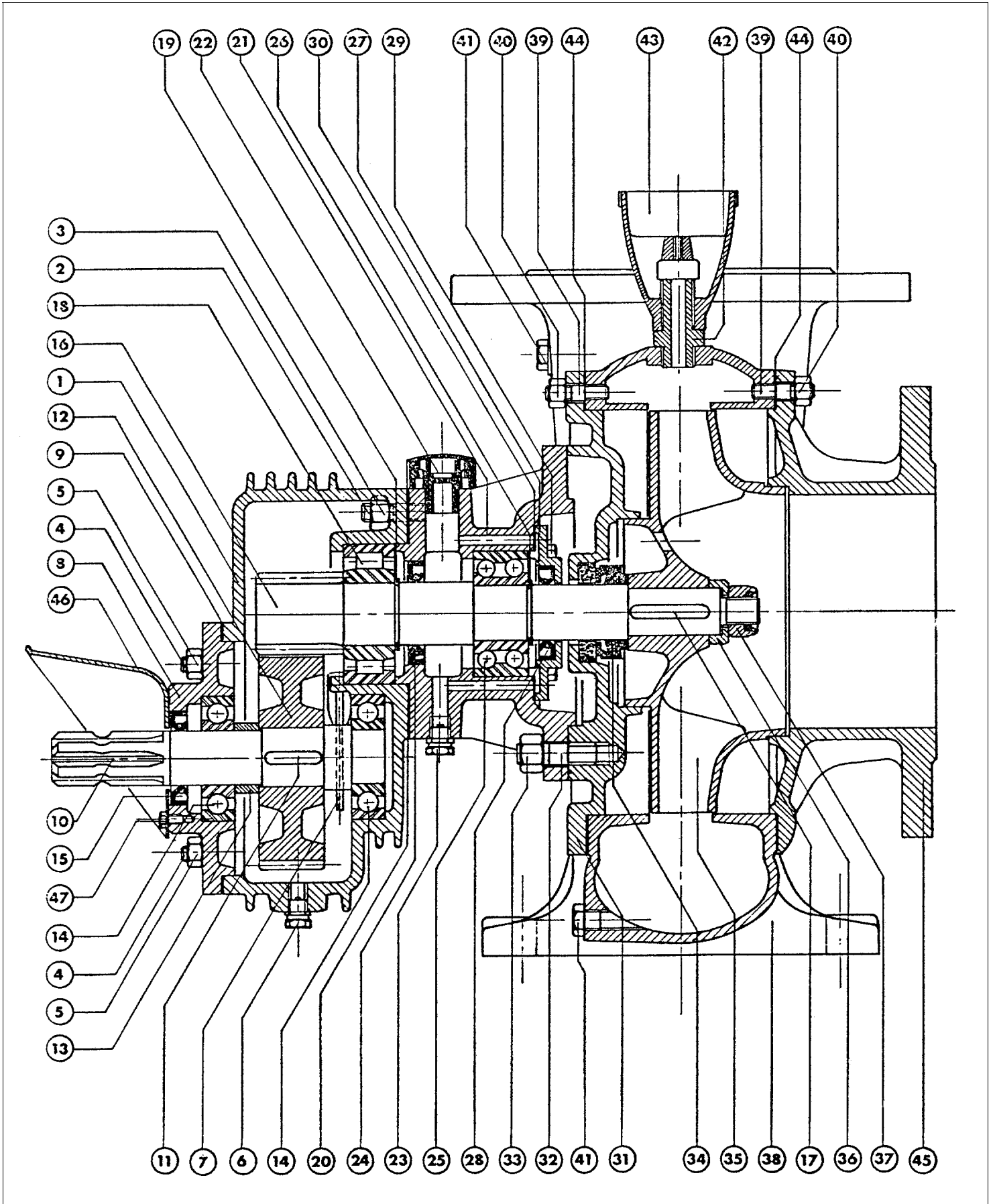

Place "RI" prefix before all part numbers before placing orders.

| POS | Item Description | MB 20 | | MB 25 | |
|-----|-------------------------------|--------|----|--------|---|
| | | Part # | Q | Part # | Q |
| 1 | Gearbox | 4926 | 1 | | |
| 2 | Bolt / Stud | VP16 | 4 | | |
| 3 | Nut / Hex | DEA12 | 4 | | |
| 4 | Bolt / Stud | VP3 | 4 | | |
| 5 | Nut / Hex | DEA10 | 4 | | |
| 6 | Plug / Magnetic | 4470 | 1 | | |
| 7 | Dipstick / Oil Level | 3405 | 1 | | |
| 8 | Cover | 4826 | 1 | | |
| 9 | Gasket * | 4830 | 1 | | |
| 10 | Shaft / PTO | 3899 | 1 | | |
| 11 | Key | LI12 | 1 | | |
| 12 | Transmission Gear Z43-R.2, 87 | 4943 | 1 | | |
| 12 | Transmission Gear Z44-R. ,14 | 4940 | 1 | | |
| 13 | Spacer | 3403 | 1 | | |
| 14 | Bearing * | CU9 | 2 | | |
| 15 | Seal /Oil * | AT7 | 1 | | |
| 16 | Shaft / Pinion Z15 – R, .2,87 | 4944 | 1 | | |
| 16 | Shaft / Pinion Z14 – R, .3,14 | 4942 | 1 | | |
| 17 | Key | LI13 | 1 | | |
| 18 | Bearing * | CU42 | 1 | | |
| 19 | Washer / Outer Spring | AFE7 | 1 | | |
| 20 | Gasket * | 4829 | 1 | | |
| 21 | Support / Over-Gear | 4924 | 1 | | |
| 22 | Plug / Breather | 3370 | 1 | | |
| 23 | Plug / Magnetic | 4470 | 1 | | |
| 24 | Seal / Oil * | AT15 | 1 | | |
| 25 | Bearing * | CU21 | 1 | | |
| 26 | Washer / Outer Spring | AFE5 | 1 | | |
| 27 | Cover | 3903 | 1 | | |
| 28 | Seal / Oil * | AT7 | 1 | | |
| 29 | Bolt / Hex | VTE2 | 4 | | |
| 30 | Gasket * | 3355 | 1 | | |
| 31 | Support / Pump | 4929 | 1 | | |
| 32 | Bolt / Stud | VP21 | 4 | | |
| 33 | Nut / Hex | DEA14 | 4 | | |
| 34 | Seal / Mechanical * | TM35 | 1 | | |
| 35 | Impeller * | 4947 | 1 | | |
| 36 | Washer | **** | | | |
| 37 | Nut / Self Locking | DA24B | 1 | | |
| 38 | Body / Pump | 2528 | 1 | | |
| 39 | Bolt / Stud | VP4 | 16 | | |
| 40 | Nut / Hex | DEA10 | 16 | | |
| 41 | Plug | NO19 | 2 | | |
| 42 | Plug | NO14 | 1 | | |
| 44 | Gasket * | 2536 | 2 | | |
| 45 | Cover / Suction | 5574 | 1 | | |
| 46 | Cover / PTO | 4477 | 1 | | |
| 47 | Bolt / Hex | VTE56 | 3 | | |

NOTE: See serial plate located on pump for ratio to indicate parts needed for POS 12 and 16.

It is useful to keep a stock of fast wearing parts on hand for quick repairs. Most recommended spare parts are marked by an asterisk (*) following part description.

1-800-Team ABI



Email abigausa@att.net
www.abi-irrigation.com



AgriBusiness International, Inc
 P.O. Box 909
 Villa Rica, Georgia 30180 USA
 Ph. 770-459-4401 Fx. 770-459-6877