

# Rovatti T2K50 Series Pump

Itemized Part Listing

11/2002

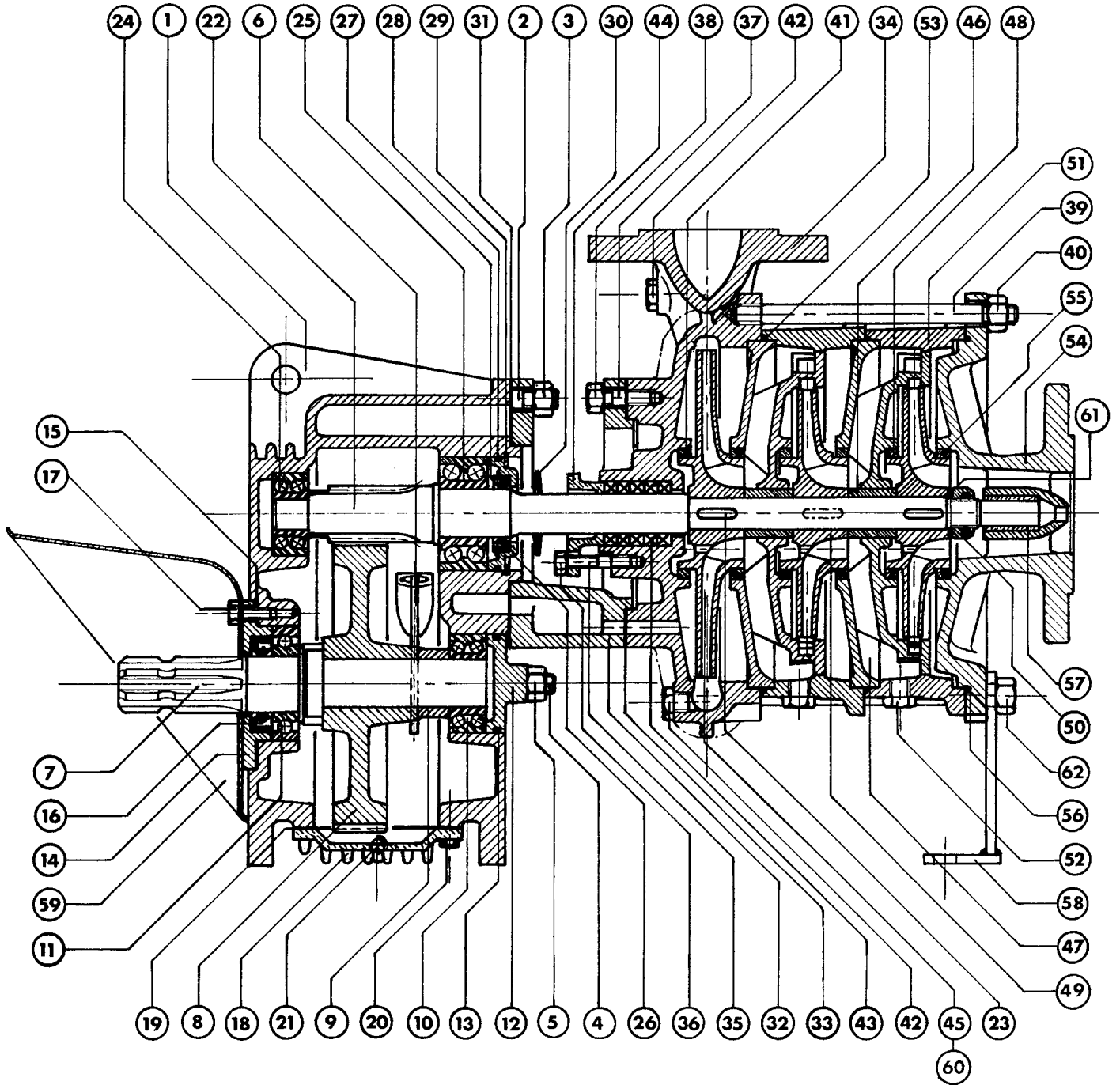

**T2K50**

POS	Item Description	Part #	Q
1	Gearbox	4106	1
2	Bolt / Stud	VP16	4
3	Nut	DEA12	4
4	Bolt	VTE27	2
5	Washer	RE12	2
6	Plug / Breather w/Dipstick	4371	1
7	Shaft / PTO	4115	1
8	Gear / Transmission Z90 – R6.43	4715	1
9	Spacer	4116	1
10	Bearing *	CU16	1
11	Bearing *	CU4	1
12	Cover	4703	1
13	O-Ring *	OR2	1
14	Cover	4379	1
15	Gasket *	4378	1
16	Seal / Oil *	AT7	1
17	Bolt	VTE2	3
18	Cover	4111	1
19	Gasket *	4723	1
20	Bolt	VTE1	8
21	Plug / Magnetic	4470	1
22	Shaft / Pinion Z14 – R6.43	5207	1
23	Key	LI20	3
24	Bearing *	CU18	1
25	Bearing *	CU20	1
26	Cover	4113	1
27	Seal / Oil *	AT2	1
28	O-Ring *	OR3	1
29	Circlip / Internal	AFI7	1
30	Ring / Water Sealing	AP2	1
31	Gasket *	4168	1
32	Support / Pump	5205	1
33	Gasket *	5237	1
34	Body / Pump	5208	1
35	Bolt / Stud	VP2	2
36	Nut	DEA8	2
37	Bolt / Stud	VP3	4
38	Nut	DEA10	4
39	Bolt / Stud	VP31	8
40	Nut	DEA12	6
41	Ring / Wear *	4485	1
42	Plug	NO19	2
43	Ring / Packing *	5639	5
44	Flange / Stuffing Box	2018	1
45	Impeller / Pump Body	4462	1
46	Spacer	4482	2
47	Diffuser	4422	2
48	Ring / Wear *	4485	4
49	Impeller / Diffuser	4460	2
50	Nut / Impeller	DA18b	1
51	Shell / Diffuser	4501	2
52	Plug	NO19	2
53	Gasket *	3486	2
54	Cover / Suction w/ Support	4504	1
55	Ring / Wear *	4485	1
56	Gasket *	3486	1
57	Bushing *	1445	1
58	Foot / Support	5212	1
59	Guard / PTO	4477	1
60	Washer	6712	1
61	Washer	RR20	1
62	Nut	DEM12	2

*Place "RI" prefix before all part numbers before placing orders.*

It is useful to keep a stock of fast wearing parts on hand for quick repairs. Most recommended spare parts are marked by an asterisk (\*) following part description.

**1-800-Team ABI**

Email [abigausa@att.net](mailto:abigausa@att.net)  
[www.abi-irrigation.com](http://www.abi-irrigation.com)

t2k50.pdf ABI 2002



**AgriBusiness International, Inc**  
 P.O. Box 909  
 Villa Rica, Georgia 30180 USA  
 Ph. 770-459-4401 Fx. 770-459-6877