

# Rovatti TCK Series Chopper

Itemized Part Listing

11/2002

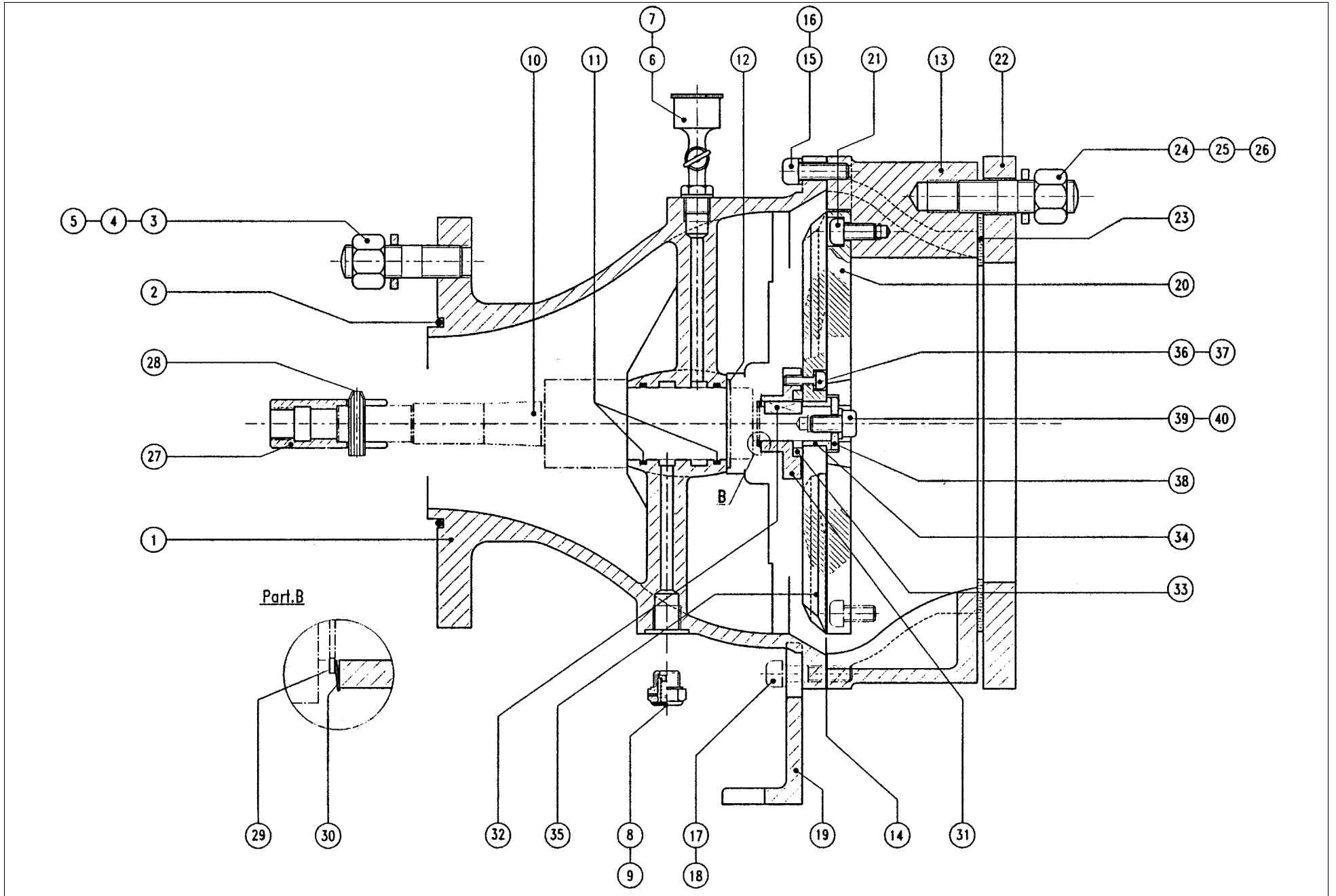

Place "RI" prefix before all part numbers before placing orders.

POS	Item Description	TCK 80		TCK 85		TCK 100		TCK 101		TCK 110	
		Part #	Q	Part #	Q	Part #	Q	Part #	Q	Part #	Q
1	Body / Chopper	9849	1	9849	1	9881	1	9881	1	9881	1
2	O-Ring *	OR45	1	OR45	1	OR45	1	OR45	1	OR45	1
3	Bolt-Stud	VP25	8	VP25	8	VP25	8	VP25	8	VP25	8
4	Nut	DEA16	8	DEA16	8	DEA16	8	DEA16	8	DEA16	8
5	Washer	RE16	8	RE16	8	RE16	8	RE16	8	RE16	8
6	Fitting /Grease	NO7	1	NO7	1	NO7	1	NO7	1	NO7	1
7	Washer	RA4	1	RA4	1	RA4	1	RA4	1	RA4	1
8	Plug/Breather	NO164	1	NO164	1	NO164	1	NO164	1	NO164	1
9	Washer	****		****		****		****		****	
10	Shaft / Chopper	9962	1	9962	1	9962	1	9962	1	9962	1
11	O-Ring *	OR53	2	OR53	2	OR53	2	OR53	2	OR53	2
12	Washer / Outer Spring	AFE17	1	AFE17	1	AFE17	1	AFE17	1	AFE17	1
13	Cover	9561	1	9561	1	9561	1	9561	1	9561	1
14	Gasket *	9050	1	9050	1	9050	1	9050	1	9050	1
15	Screw	VTCEI1	6	VTCEI1	6	VTCEI1	6	VTCEI1	6	VTCEI1	6
16	Washer	RE8	6	RE8	6	RE8	6	RE8	8	RE8	6
17	Screw	VTCEI7	2	VTCEI7	2	VTCEI7	2	VTCEI7	2	VTCEI7	2
18	Washer	RE8	2	RE8	2	RE8	2	RE8	2	RE8	2
19	Support Foot	9059	1	9059	1	9059	1	9059	1	9059	1
20	Blade / Fixed *	9592	1	9592	1	9592	1	9592	1	9592	1
21	Screw	VTCEI47	2	VTCEI47	2	VTCEI47	2	VTCEI47	2	VTCEI47	2
22	Flange	9222	1	9222	1	9222	1	9222	1	9222	1
23	Gasket *	8094	1	8094	1	8094	1	8094	1	8094	1
24	Bolt-Stud	VP25	8	VP25	8	VP25	8	VP25	8	VP25	8
25	Nut	DEA16	8	DEA16	8	DEA16	8	DEA16	8	DEA16	8
26	Washer	RE16	8	RE16	8	RE16	8	RE16	8	RE16	8
27	Coupling O18-M20 *	9053	1	****		9054	1	****		****	
27	Coupling O18-M16 *	****		9374	1	****		****		9053	1
27	Coupling *	****		****		****		9634	1	****	
28	Pin Taper	NO182	1	NO182	1	NO182	1	NO182	1	NO182	1
29	Washer / Outer Spring	AFE16	1	AFE16	1	AFE16	1	AFE16	1	AFE16	1
30	Spring	NO115	1	NO115	1	NO115	1	NO115	1	NO115	1
31	Hub	9834	1	9834	1	9834	1	9834	1	9834	1
32	Key	LI3	1	LI3	1	LI3	1	LI3	1	LI3	1
33	Ring	9055	1	9055	1	9055	1	9055	1	9055	1
34	Bearing *	9835	1	9835	1	9835	1	9835	1	9835	1
35	Blade / Rotating *	9591	1	9591	1	9591	1	9591	1	9591	1
36	Screw	VTCEI40	1	VTCEI40	1	VTCEI40	1	VTCEI40	1	VTCEI40	1
37	Washer	RE5	1	RE5	1	RE5	1	RE5	1	RE5	1
38	Washer	9569	1	9569	1	9569	1	9569	1	9569	1
39	Screw	VTCEI47	1	VTCEI47	1	VTCEI47	1	VTCEI47	1	VTCEI47	1
40	Washer	RE8	1	RE8	1	RE8	1	RE8	1	RE8	1

Place "RI" prefix before all part numbers before placing orders.

NOTE: See serial plate located on pump for ratio to indicate parts needed for POS 27.

It is useful to keep a stock of fast wearing parts on hand for quick repairs. Most recommended spare parts are marked by an asterisk (\*) following part description.

**1-800-Team ABI**



Email [abigausa@att.net](mailto:abigausa@att.net)  
[www.abi-irrigation.com](http://www.abi-irrigation.com)



**AgriBusiness International, Inc**  
 P.O. Box 909  
 Villa Rica, Georgia 30180 USA  
 Ph. 770-459-4401 Fx. 770-459-6877

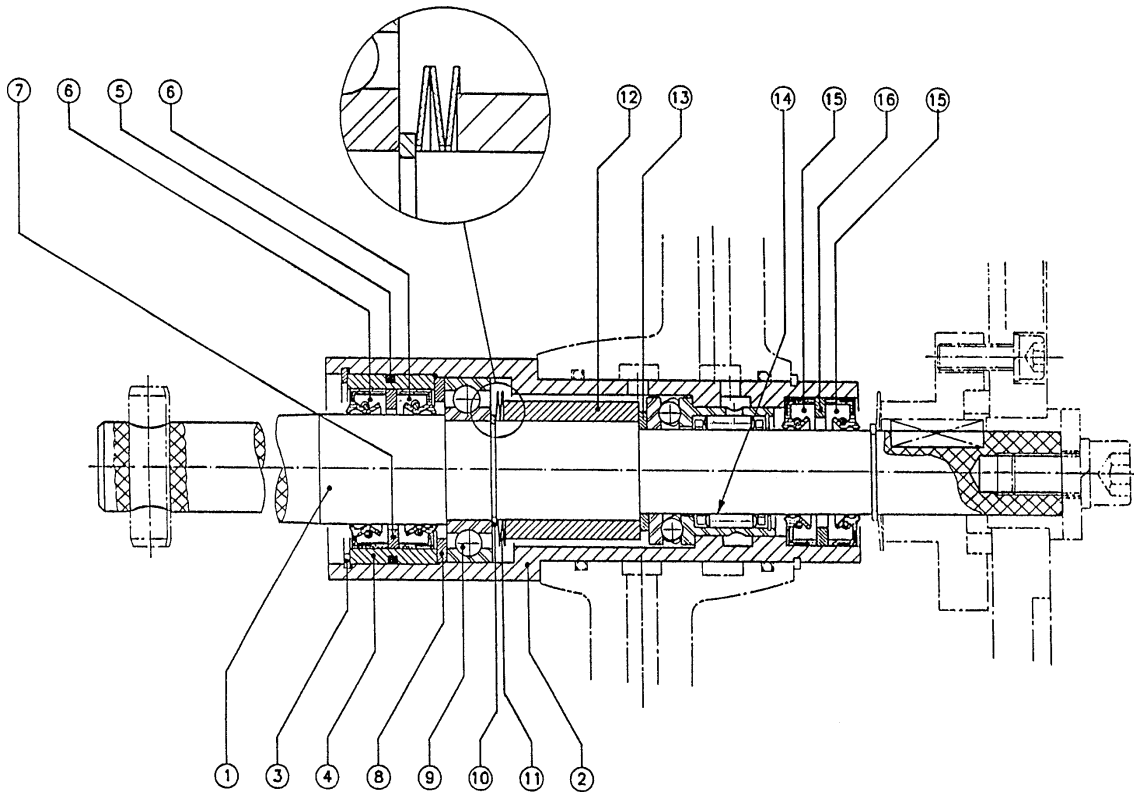

POS	Item Description	TCK	
		Part #	Q
1	Shaft	9838	1
2	Support / bearing	9839	1
3	Circlip / Internal	AFI20	1
4	Bushing	9837	1
5	O-Ring	OR26	1
6	Seal / Oil	AT38	2
7	Washer	RR17	1
8	Washer	RR16	1
9	Bearing	CU94	1
10	Circlip / External	AFE13	1
11	Spring	NO163	3
12	Spacer	9836	1
13	Washer	RR14	1
14	Bearing	CU95	1
15	Seal / Oil	AT37	2
16	Washer	RR15	1

*Place "RI" prefix before all part numbers before placing orders.*

It is useful to keep a stock of fast wearing parts on hand for quick repairs. Most recommended spare parts are marked by an asterisk (\*) following part description.

**1-800-Team ABI**

Email [abigausa@att.net](mailto:abigausa@att.net)  
[www.abi-irrigation.com](http://www.abi-irrigation.com)



**AgriBusiness International, Inc**  
P.O. Box 909  
Villa Rica, Georgia 30180 USA  
Ph. 770-459-4401 Fx. 770-459-6877